



WILLISTON STATE COLLEGE CAMPUS MAP

1410 UNIVERSITY AVENUE, WILLISTON, ND 58801

701.774.4200 or 1.888.863.9455

www.willistonstate.edu

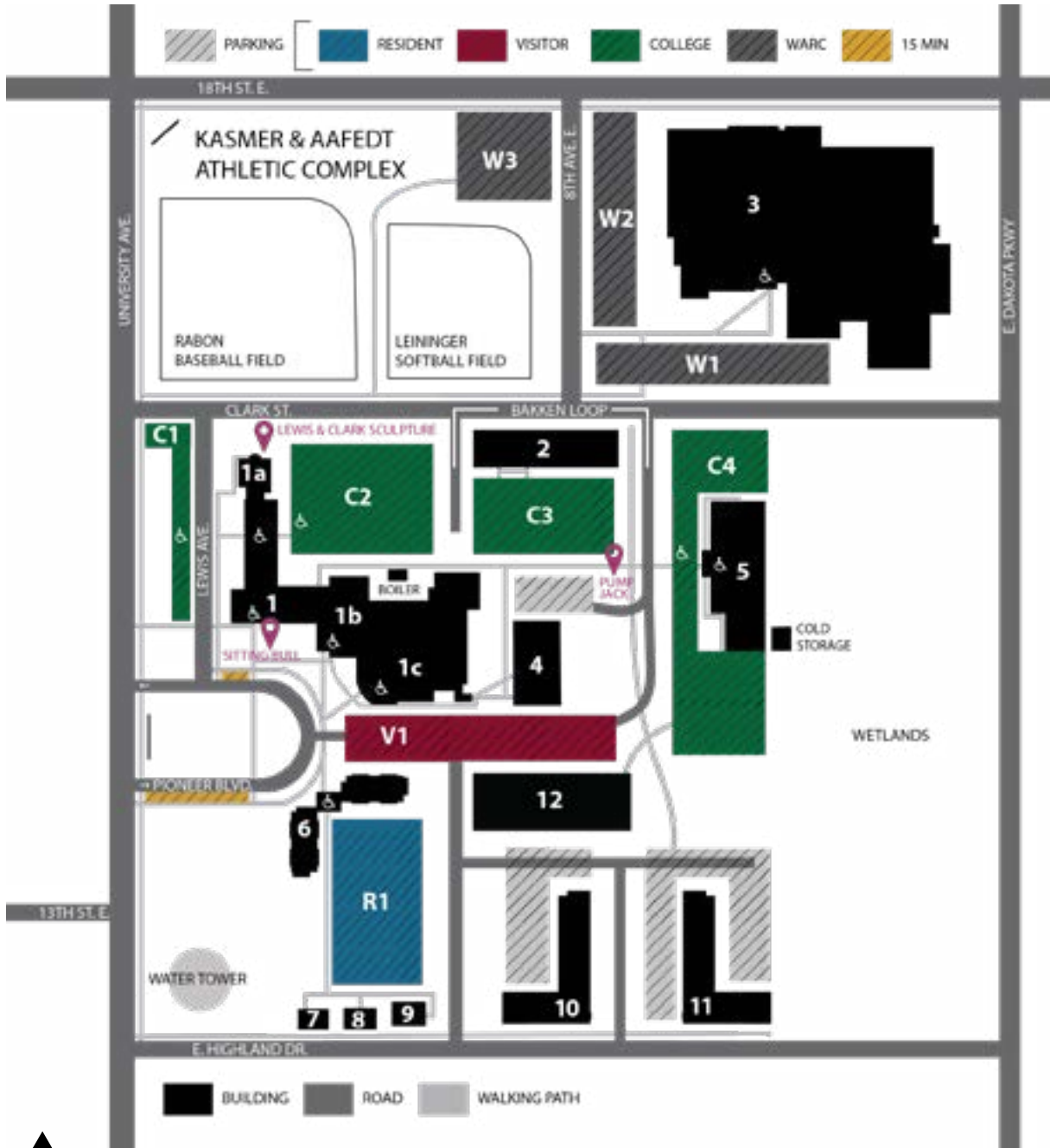

1. STEVENS HALL

Classrooms, Learning Commons (library), Academic Affairs, Student Services, Teton Grill, Andrea's (bookstore), Skadeland Gymnasium, Teton Lounge, Student Life, Counselor and Administrative, Marketing, Staff and Faculty offices.

1a. SCIENCE CENTER

Labs and Faculty offices for Biology, Anatomy, Physics and Chemistry.

1b. LEONARD P. NELSON HEALTH & WELLNESS WING

Health, Physical Education and Nursing classes.

1c. THOMAS WITT LEACH COMPLEX (THE WELL)

2,200-seat sports arena, walking track, weight room and Athletic offices.

2. CRIGHTON BUILDING

Classrooms, labs and offices for Diesel Technology program.

3. WILLISTON AREA RECREATION CENTER

Community Rec Center with indoor walking/running tracks, cardio/weight lifting areas and indoor waterpark.

4. ART WOOD BUILDING

Campus Services offices.

5. WESTERN STAR CAREER AND TECHNOLOGY CENTER

Business/Technology, Art, Welding, Ag, Petroleum and Massage Therapy classrooms, labs and Faculty offices. Also houses Adult Education and GED Testing

6. FRONTIER HALL (CAMPUS HOUSING)

7. ABRAMSON HALL (CAMPUS HOUSING)

8. MANGER HALL (CAMPUS HOUSING)

9. NELSON HALL (CAMPUS HOUSING)

10. WSC FOUNDATION APARTMENTS II

11. WSC FOUNDATION APARTMENTS I

WSC Foundation. Retail space on lower level includes: Jimmy Johns.

12. HEALTHCARE TRAINING FACILITY

Healthcare program classrooms & clinical labs for Nursing, Massage Therapy, CMA, etc.

WORKFORCE TRAINING CAMPUS [TRAINND]

Located in the industrial park on the east side of Williston.

WORKFORCE TRAINING CENTER | 415 22ND AVE NE

PETROLEUM SAFETY & TECH CENTER | 421 22ND AVE NE

safety.training@willistonstate.edu

willistonstate.edu/trainND | 701.572.2835





 **FACULTY/STAFF OFFICES**

 **CLASSROOMS**

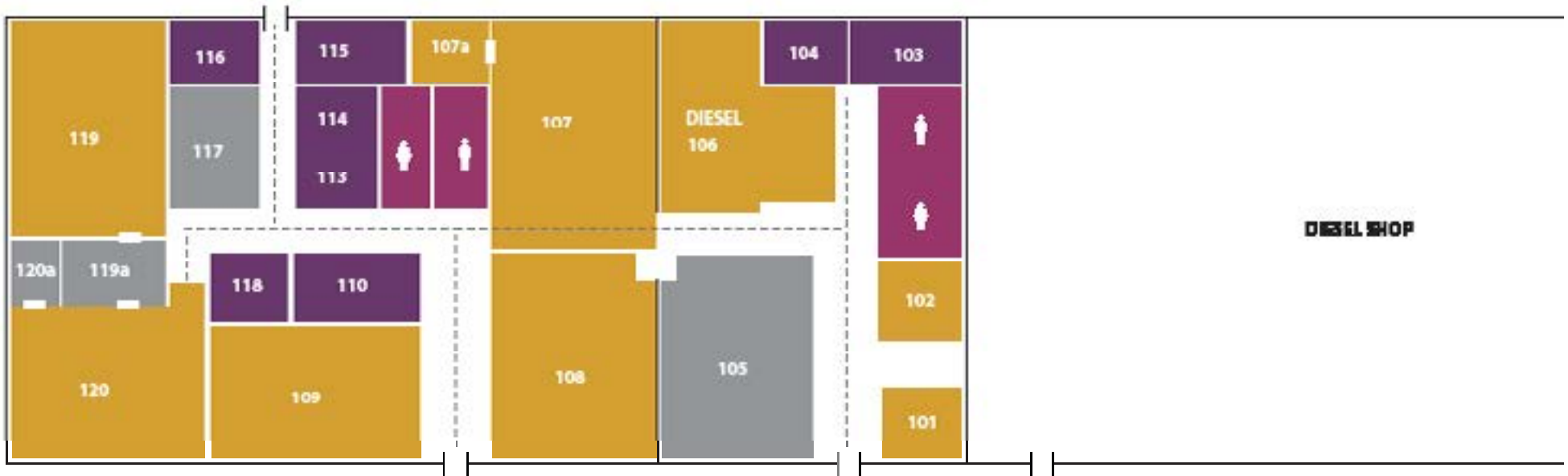





WILLISTON STATE COLLEGE WESTERN STAR [CTE]

1410 UNIVERSITY AVENUE, WILLISTON, ND 58801

701.774.4200 or 1.888.863.9455

www.willistonstate.edu

-  FACULTY/STAFF OFFICES
-  STUDY AREAS
-  CLASSROOMS



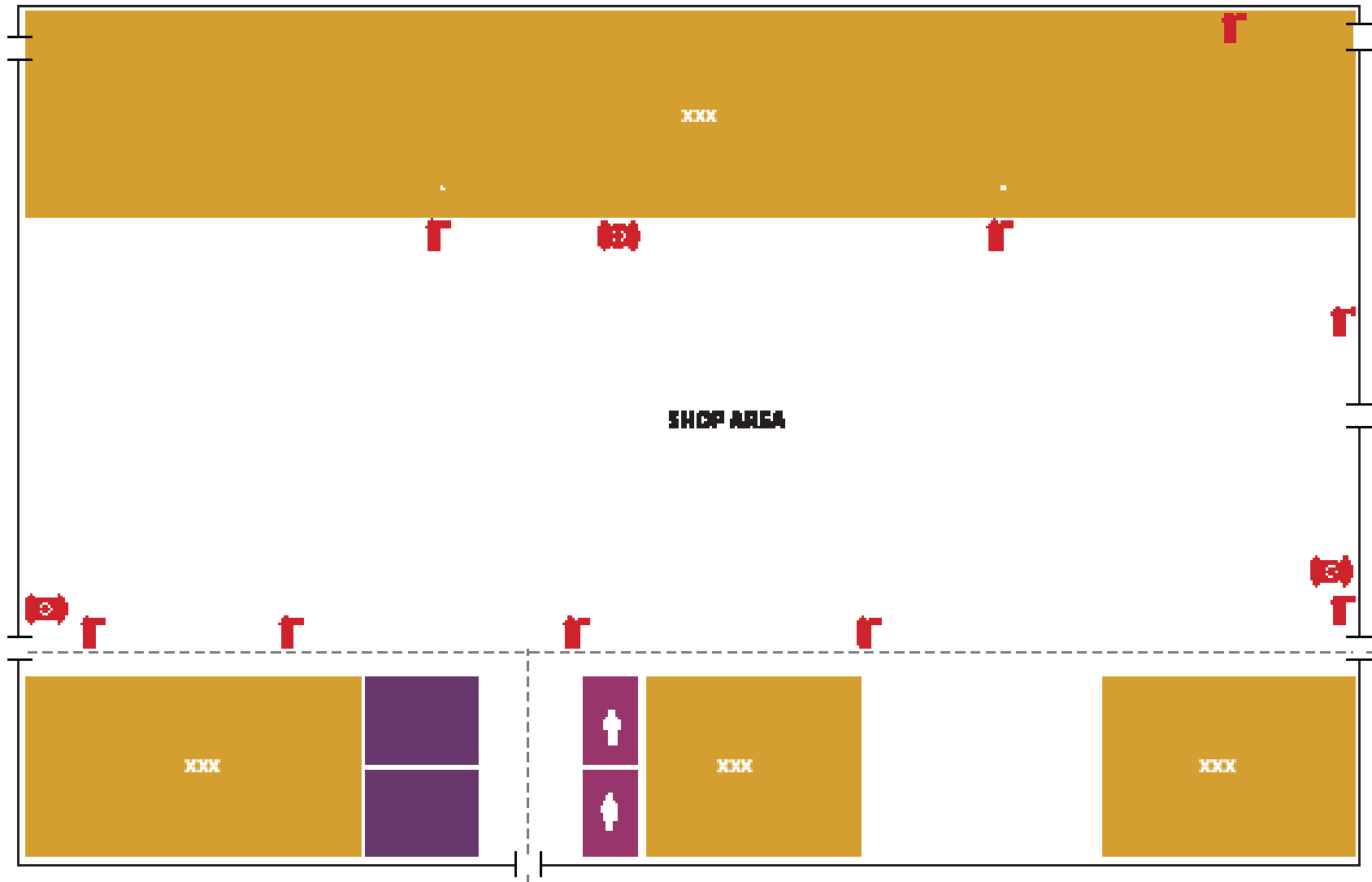

Located in the industrial park on the east side of Williston beyond the main campus.

1. **WORKFORCE TRAINING CENTER** | 415 22nd Ave NE
2. **PETROLEUM CENTER** | 421 22nd Ave NE

safety.training@willistonstate.edu | willistonstate.edu/trainND | 701.572.2835

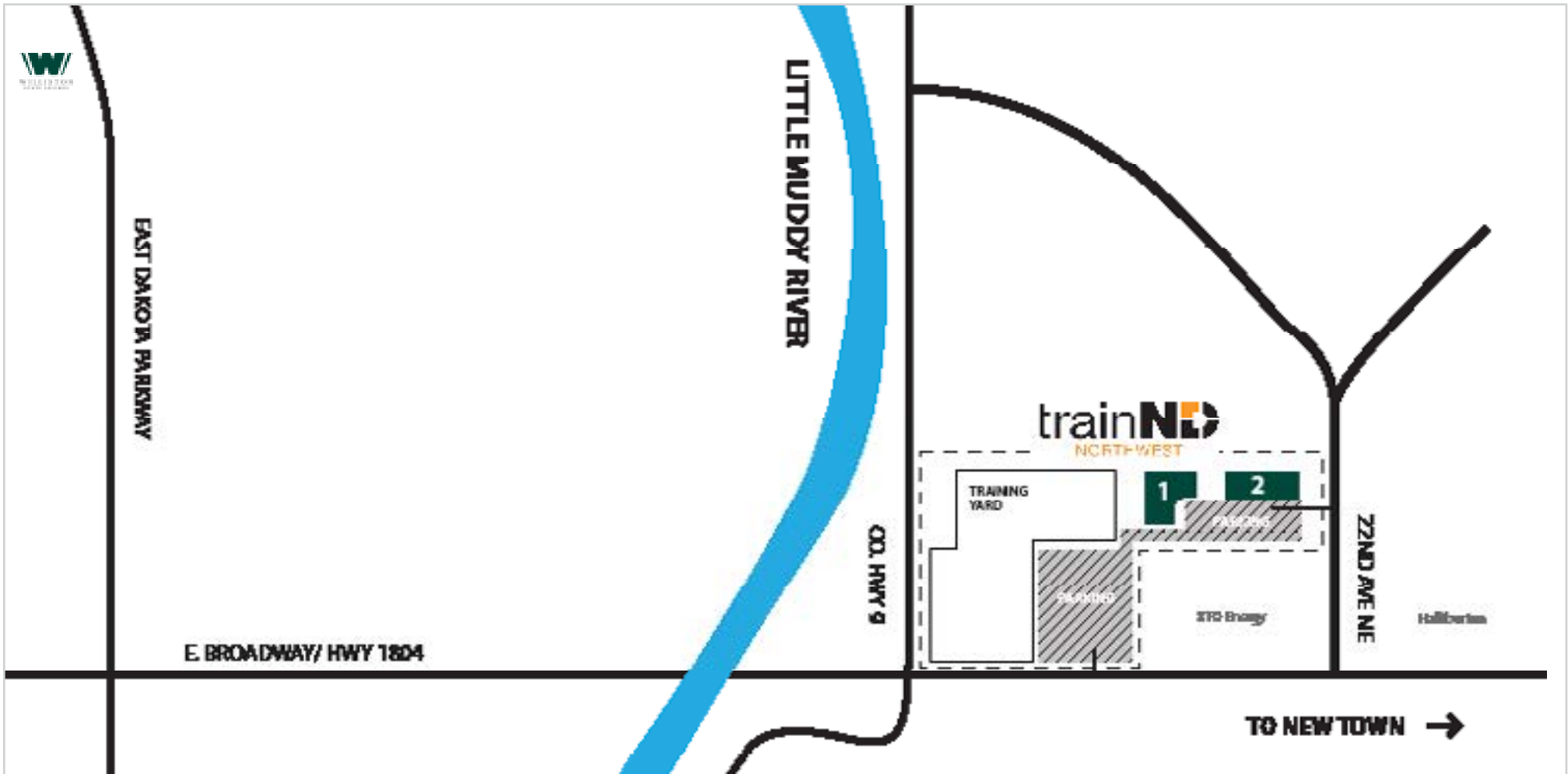

From WSC take University or E. Dakota Parkway South to E. Broadway/HWY 1804
TURN LEFT (East) on E. Broadway/HWY 1804
TURN LEFT (North) on 22nd Ave NE
It's the second building on the left behind XTO Energy

